

### **Rapid Waterproofing Plugging Compound**

- 2 minutes setting time
- stops flowing water
- installation of pipes in manholes
- designed for use in sewers and manholes

#### **PRODUCT DESCRIPTION**

A cementitious, ready-mixed, rapid setting compound to stop water and moisture ingress.

#### **AREAS OF APPLICATION**

VANDEX RAPID 2 can be used internally or externally as a waterproof plugging mortar or where rapid setting and early strength gain is required:

- Plugging water leaks and seepage
- Sealing leaking pipes
- Sealing leaking cracks
- Sealing wet surfaces
- Plugging leaks in earthenware pipes
- Caulking segment joints in manholes
- Fixings in water structures where immediate use is required
- Installation of steel elements in concrete or masonry
- Erosion resistant shoring of canal sealing
- Underwater work

VANDEX RAPID 2 can be used on the following substrates:

- Concrete
- Masonry
- Earthenware
- Cast iron pipes
- Plastics pipes
- Stone

#### **PROPERTIES**

VANDEX RAPID 2 has the following physical properties:

- Stops water flow
- Sets in approx. 2 minutes after mixing
- Durable, no shrinkage
- Can be used underwater
- Can be mixed with water or used dry
- Easy application
- Packaged in easy to use, resealable containers

#### **SURFACE PREPARATION**

The substrate must be clean, sound and free of any surface contamination. Leaks must be cut out back to sound material, leaving an appropriate chase for receiving the VANDEX RAPID 2.

#### **MIXING**

Mix 1 kg VANDEX RAPID 2 and 0.20–0.25 l of clean water to a stiff plastic consistency. In cold weather, use lukewarm water. In higher temperatures, use cold water. To avoid wastage, only small quantities of VANDEX RAPID 2 should be mixed.

#### **APPLICATION**

- After mixing, apply the VANDEX RAPID 2 to the appropriate area immediately. Work the mixture well into the area and then hold firmly in place for about 1–2 minutes (Wear rubber gloves).
- Maintain pressure without disturbing the material, until it has set.
- Remove excess material.
- After lightly prewetting apply a normal Vandex waterproofing coating.

In certain circumstances VANDEX RAPID 2 may be applied as a dry powder.

#### **CURING**

Avoid strong mechanical load 1 hour after application. Provide suitable protection from extreme weather conditions (e.g. rain, sun, wind, frost) while setting.

#### **CONSUMPTION**

Installation of a 30 cm diameter pipe requires 2–3 kg.

#### **PACKAGING**

15-kg-plastic, resealable buckets.

#### **STORAGE**

When stored in a dry place in unopened, undamaged original packaging, shelf life is 12 months.

#### **HEALTH AND SAFETY**

VANDEX RAPID 2 contains cement. Irritating to skin. Risk of serious damage to eyes. – Keep out of reach of children. Do not breathe dust. Avoid contact with skin and eyes. In case of contact with eyes, rinse immediately with plenty of water and seek medical advice. Wear suitable gloves and eye/face protection.

For further information please refer to Material Safety Data Sheet on [www.vandex.com](http://www.vandex.com).

TECHNICAL DATA	
Aggregate state	powder
Coulour	grey
Bulk density [kg/l]	approx. 1.4
Components	1 component
Application temperature (mixing water and substrate temperature) [°C]	+5 to +25
Setting time (after mixing) [min]	approx. 2
Compressive strength (10 °C) [N/mm <sup>2</sup> ]	1 h: 4.0 6 h: 6.0 24 h: 14.0 28 days (stored in water): 40.0
Bending tensile strength (10 °C) [N/mm <sup>2</sup> ]	28 days (stored in water): 8.0
All data are averages of several tests under laboratory conditions. In practice, climatic variations such as temperature, humidity, and porosity of substrate may affect these values.	

The information contained herein is based on our long-term experience and the best of our knowledge. We can, however, make no guarantee since for a successful outcome, all circumstances in an individual case must be taken into consideration. Indications of quantities required are only averages which in certain cases might be greater.



## CONCRETE PROTECTION AND WATERPROOFING

An **RPM** Company

### HEADOFFICE AND INTERNATIONAL SALES: VANDEX INTERNATIONAL LTD

P.O. Box, CH-4501 Solothurn/Switzerland  
Phone: +41 32 626 36 36, Fax +41 32 626 36 37  
E-mail: [info@vandex.com](mailto:info@vandex.com) [www.vandex.com](http://www.vandex.com)



### PRODUCTION AND SALES GERMANY/AUSTRIA: VANDEX ISOLIERMITTEL-GESELLSCHAFT m.b.H.

P.O. Box, 1406, D-21487 Schwarzenbek/Germany  
Phone: +49 4151 89 15-0, Fax +49 4151 89 15 50  
E-mail: [info@vandex.de](mailto:info@vandex.de) [www.vandex.de](http://www.vandex.de)

RAPID REPAIR AND COATING SYSTEMS  
– TIME IS IMPORTANT...

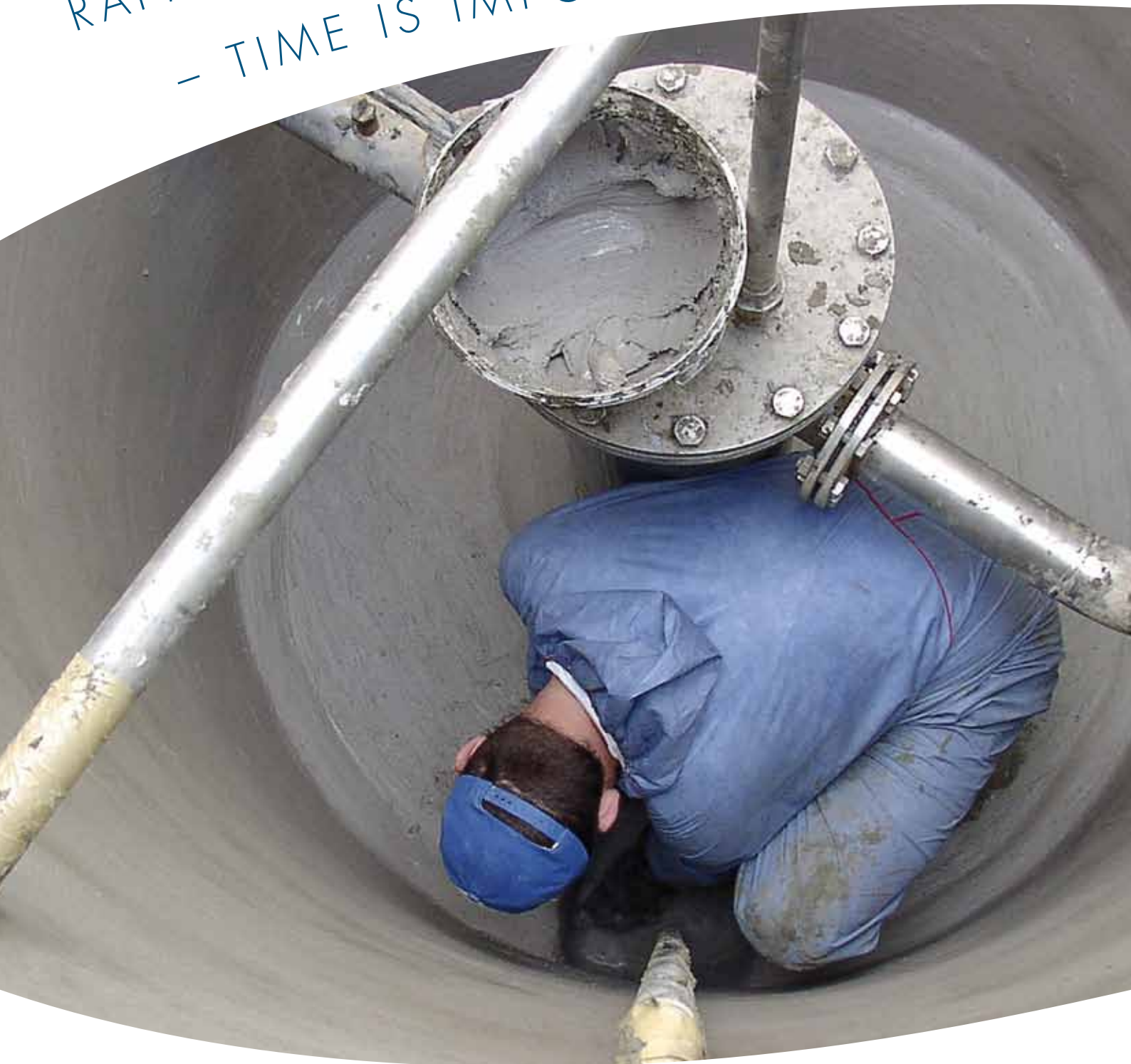

## **VANDEX RAPID SYSTEM – true problem solver**

The four products in the VANDEX RAPID SYSTEM range are true problem solvers. Their waterproofing properties develop even when in contact with running water. Only hours after application the products are capable of withstanding maximum load, resulting in minimal interruption of the wastewater flow. Furthermore the products are resistant to domestic sewage.

## **Chemically resistant waterproof coating – in a few hours**

Due to its composition of cement, quartz with graded grain-size distribution and special chemical ingredients of an inorganic nature, the VANDEX RAPID SYSTEM product range cures completely within a few hours. The waterproof coating formed is highly resistant to abrasion and chemicals.

## **Repair or maintenance – no compromise**

In sewage systems there are many areas such as manholes, collectors and treatment plants which require repair or maintenance, but often can only be shut down for a short period of time. A repair and refurbishment system allowing this with a downtime as low as just 4–6 hours is often required. The VANDEX RAPID SYSTEM offers this without compromising the quality of the repairs.

## **Areas of application**

- Manholes
- Sewers
- Collectors
- Treatment plants
- Pipe junctions/connections
- Tunnels
- Below ground structures

## **Advantages**

- ✓ Rapid setting
- ✓ Cures in a few hours
- ✓ Immediately resistant to load
- ✓ Short and predictable downtime
- ✓ Designed for use in sewers and manholes

## **Typical damage to repair**

- ☐ Ground water ingress
- ☐ Damaged joints
- ☐ Cracks
- ☐ Corroded concrete
- ☐ Leaking pipes and junctions

**TIME IS IMPORTANT...**



**The VANDEX RAPID SYSTEM at work...**



*The leaking area*



*Substrate preparation*



*Sealing of leaking joints*



*Sealing of leaking points*



*Applying a covered fillet at wall / floor junction*



*Waterproofing the surface*

## Basement

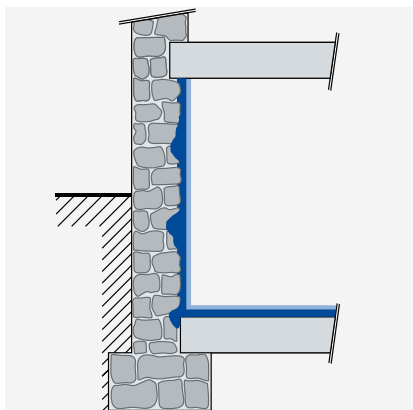

## Pipe Inlet

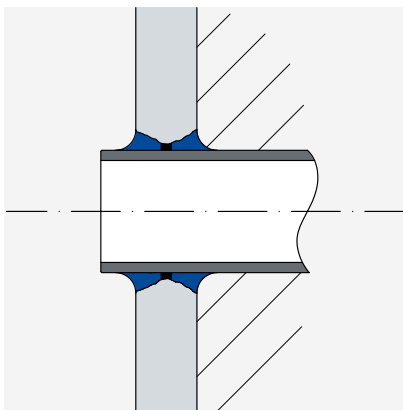

## Manhole

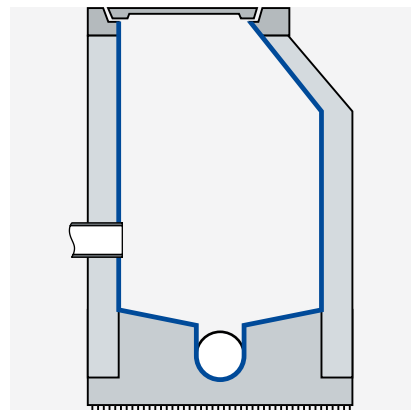

# THE VANDEX RAPID SYSTEM

## VANDEX RAPID S

### Rapid waterproofing slurry

- After 3 hours – resistant to load
- For concrete, masonry and render
- As sealing and interior coating
- Designed for use in sewers and manholes

## VANDEX RAPID M

### Rapid waterproof repair mortar

- After 1 hour – resistant to load
- Waterproof at 10 mm layer thickness
- For horizontal and vertical application
- Designed for use in sewers and manholes

## VANDEX RAPID XL

### Rapid repointing mortar

- After 2 hours – resistant to load
- 100 mm applicable in one working cycle
- Fibre reinforced
- Designed for use in sewers and manholes

## VANDEX RAPID 2

### Rapid waterproof plugging compound

- 2 minutes setting time
- Stops flowing water
- Installation of pipes in manholes
- Designed for use in sewers and manholes



VX.B.RAP.en.1605



### RPM/Belgium N.V.

H. Dunantstraat 11B · B-8700 Tielt · T.:+32 (0) 51 40 38 01

### Alteco Technik GmbH

Raiffeisenstraße 16 · D-27239 Twistringen · T.:+49 (0) 42 43 92 95 0

### Hermeta GmbH

Kanalstraße 11 · D-12357 Berlin · T.:+49 (0) 30 661 70 72

### Monile France SARL

10, rue de la Lande · F-35430 St. Jovan des Guerets · T.:+33 (0) 608 86 96 56

### Vandex International Ltd

Rötistrasse 6 · CH-4501 Solothurn · T.:+41 (0) 32 626 36 36

### Vandex Isoliermittel-GmbH

Industriestraße 19–23 · D-21493 Schwarzenbek · T.:+49 (0) 41 51 89 15 0

### Vandex AG

Rötistrasse 6 · CH-4501 Solothurn · T.:+41 (0) 32 626 36 46

### Alteco Polymer Systems

436 Seventh Avenue, Suite 1850 · Pittsburgh, PA 15219 · T.: +1 216 258 8715